

IKO PLC

Appley Lane North
Appley Bridge
Wigan
Lancashire WN6 9AB

Tel: 01257 255771 Fax: 01257 252514

e-mail: technical.uk@ikogroup.com

website: www.ikogroup.co.uk



Agrément Certificate

15/5190

Product Sheet 6

BUILDBASE SUPPLIED BY IKO — BREATHER MEMBRANE

FOR USE IN TIMBER FRAME CONSTRUCTIONS

This Agrément Certificate Product Sheet⁽¹⁾ relates to Buildbase Supplied By IKO — Breather Membrane for use in timber-frame walls with a cavity and a masonry outer leaf, weatherboarding, or tile/slate cladding.

(1) Hereinafter referred to as 'Certificate'.

CERTIFICATION INCLUDES:

- factors relating to compliance with Building Regulations where applicable
- factors relating to additional non-regulatory information where applicable
- independently verified technical specification
- assessment criteria and technical investigations
- design considerations
- installation guidance
- regular surveillance of production
- formal three-yearly review.

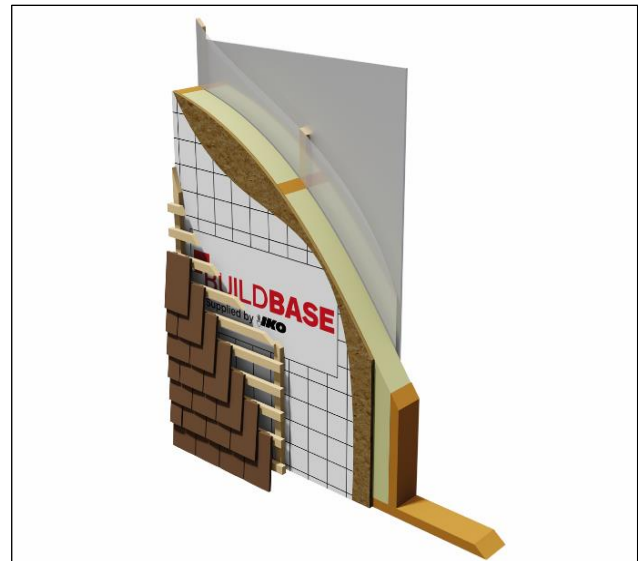

KEY FACTORS ASSESSED

Weathertightness — the product will contribute to protecting a wall against water penetration (see section 6).

Risk of condensation — the product has low water vapour transmission and can contribute to reducing the risk of interstitial condensation (see section 7).

Strength — the product has adequate strength to resist damage during construction of the walls (see section 8).

Properties in relation to fire — the product is classified as Class E in accordance with BS EN 13501-1 : 2007 and their use is restricted in some cases by the national Building Regulations (see section 9).

Durability — the product will have a life equal to that of the building in which it is installed (see section 11).

The BBA has awarded this Certificate to the company named above for the product described herein. This product has been assessed by the BBA as being fit for its intended use provided it is installed, used and maintained as set out in this Certificate.

On behalf of the British Board of Agreement

Date of First issue: 30 November 2015

John Albon — Head of Approvals
Construction Products

Claire Curtis-Thomas
Chief Executive

Certificate amended on 11 February 2019 to include Requirement B4(1) and associated test.

The BBA is a UKAS accredited certification body – Number 113.

*The schedule of the current scope of accreditation for product certification is available in pdf format via the UKAS link on the BBA website at www.bbacerts.co.uk
Readers are advised to check the validity and latest issue number of this Agrément Certificate by either referring to the BBA website or contacting the BBA direct.*

Any photographs are for illustrative purposes only, do not constitute advice and should not be relied upon.

British Board of Agrément

Bucknalls Lane
Watford
Herts WD25 9BA

©2015

tel: 01923 665300
clientservices@bbacerts.co.uk
www.bbacerts.co.uk

Regulations

In the opinion of the BBA, Buildbase Supplied By IKO — Breather Membrane for use in Timber Frame Constructions, if installed, used and maintained in accordance with this Certificate, can satisfy or contribute to satisfying the relevant requirements of the following Building Regulations (the presence of a UK map indicates that the subject is related to the Building Regulations in the region or regions of the UK depicted):



The Building Regulations 2010 (England and Wales) (as amended)

Requirement:	B3(3)(4)	External fire spread
Comment:	The product can contribute to satisfying this Requirement. See section 9.1 of this Certificate.	
Requirement:	B4(1)	External fire spread
Comment:	The product is restricted by this Requirement. See section 9 of this Certificate.	
Requirement:	C2(b)	Resistance to moisture
Comment:	The product will contribute to a wall meeting this Requirement. See section 6.1 of this Certificate.	
Regulation:	7	Materials and workmanship (applicable to Wales only)
Regulation:	7(1)	Materials and workmanship (applicable to England only)
Comment:	The product is acceptable. See section 11 and the <i>Installation</i> part of this Certificate.	



The Building (Scotland) Regulations 2004 (as amended)

Regulation:	8(1)	Durability, workmanship and fitness of materials
Comment:	The product can contribute to a construction satisfying this Regulation. See section 11 and the <i>Installation</i> part of this Certificate.	
Regulation:	9	Building standards applicable to construction
Standard:	2.4	Cavities
Comment:	The products can contribute to satisfying this Standard with respect to clause 2.4.2 ⁽¹⁾⁽²⁾ . See section 9.1 of this Certificate.	
Standard:	3.10	Precipitation
Comment:	The product will contribute to a wall satisfying clauses 3.10.1 ⁽¹⁾⁽²⁾ and 3.10.5 ⁽¹⁾⁽²⁾ of this Standard. See section 6.1 of this Certificate.	
Standard:	3.15	Condensation
Comment:	The product can enable a wall to satisfy this Standard with respect to interstitial condensation with reference to clauses 3.15.1 ⁽¹⁾ and 3.15.4 ⁽¹⁾ of this Standard. See section 7.1 of this Certificate.	
Standard:	7.1(a)	Statement of sustainability
Comment:	The product can contribute to meeting the relevant requirements of Regulation 9, Standards 1 to 6 and therefore will contribute to a construction meeting a bronze level of sustainability as defined in this Standard.	
Regulation:	12	Building standards applicable to conversions
Comment:	All comments given for this product under Regulation 9, Standards 1 to 6 also apply to this Regulation, with reference to clause 0.12.1 ⁽¹⁾⁽²⁾ and Schedule 6 ⁽¹⁾⁽²⁾ .	

(1) Technical Handbook (Domestic)

(2) Technical Handbook (Non-Domestic).



The Building Regulations (Northern Ireland) 2012 (as amended)

Regulation:	23(a)(i)	Fitness of materials and workmanship
Comment:	(iii)(b)(i)	The product is acceptable. See section 11 and the <i>Installation</i> part of this Certificate.
Regulation:	28(b)	Resistance to moisture and weather
Comment:		The product will contribute to a wall satisfying this Regulation. See section 6.1 of this Certificate.
Regulation:	29	Condensation
Comment:		The product can enable a wall to satisfy the Regulation. See section 7.1 of this Certificate.
Regulation:	35(3)(4)	Internal fire spread - structure
Comment:		The product can contribute to satisfying this Regulation. See section 9.1 of this Certificate.

Construction (Design and Management) Regulations 2015

Construction (Design and Management) Regulations (Northern Ireland) 2007

Information in this Certificate may assist the client, Principal Designer/CDM co-ordinator, designer and contractors to address their obligations under these Regulations.

See section: 1 *Description* of this Certificate.

Additional Information

NHBC Standards 2014

NHBC accepts the use of Buildbase Supplied By IKO — Breather Membrane for use in Timber Frame Constructions, provided it is installed, used and maintained in accordance with this Certificate, in relation to *NHBC Standards*, Chapter 6.2 *External timber framed walls*.

CE marking

The Certificate holder has taken the responsibility of CE marking the product in accordance with harmonised European Standard EN 13859-2 : 2014. An asterisk (*) appearing in this Certificate indicates that data shown are given in the manufacturer's Declaration of Performance.

Technical Specification

1 Description

Buildbase Supplied By IKO — Breather Membrane for use in Timber Frame Constructions is a thermally-bonded film laminate composite made of polyolefins. The product has the nominal characteristics given in Table 1.

Table 1 Nominal characteristics

Characteristic (unit)	Buildbase Supplied By IKO
Thickness (mm)	0.43
Mass per unit area* ($\text{g}\cdot\text{m}^{-2}$)	120
Roll length* (m)	50
Roll width* (m)	1.0, 1.5
Colour upper lower	grey grey
Tensile strength* ($\text{N}\cdot 50\text{ mm}^{-1}$) longitudinal transverse	200 110
Elongation* (%) longitudinal transverse	60 60
Tear resistance* (N) longitudinal transverse	80 70
Watertightness* unaged aged ⁽¹⁾	W1 W1
Water vapour transmission* (S_d)	0.05

(1) Aged in accordance with BS EN 13859-2 : 2014, Annex C.

2 Manufacture

2.1 The membrane is manufactured by a thermal-bonding process in which a polypropylene breathable film is bonded together with polypropylene non-woven membranes to form a flexible sheet.

2.2 As part of the assessment and ongoing surveillance of product quality, the BBA has:

- agreed with the manufacturer the quality control procedures and product testing to be undertaken
- assessed and agreed the quality control operated over batches of incoming materials
- monitored the production process and verified that it is in accordance with the documented process
- evaluated the process for management of nonconformities
- checked that equipment has been properly tested and calibrated
- undertaken to carry out the above measures on a regular basis through a surveillance process, to verify that the specifications and quality control being operated by the manufacturer are being maintained.

3 Delivery and site handling

3.1 Rolls are delivered to site individually wrapped in polythene bearing the BBA logo including the number of this Certificate.

3.2 The rolls should be stored flat or on end on a clean, level surface, kept under cover and protected from sunlight.

Assessment and Technical Investigations

The following is a summary of the assessment and technical investigations carried out on Buildbase Supplied By IKO — Breather Membrane for use in Timber Frame Constructions.

4 Use

4.1 Buildbase Supplied By IKO — Breather Membrane for use in Timber Frame Constructions is satisfactory for use as an on-site or factory-applied breather membrane in timber frame walls with a cavity and a masonry outer leaf, weatherboarding or tile/slate cladding.

4.2 In the absence of other guidance, suitable timber-frame walls are defined as those designed and built in accordance with *NHBC Standards*, Chapter 6.2 *External timber framed walls*.

4.3 The product meets the requirement for a class W1* material in accordance with BS EN 13859-2 : 2014 and meets the NHBC requirement given in *NHBC Standards*, Chapter 6.2, clause M5, as a high-performance breather membrane for use in very severe conditions. Very severe conditions are defined in NHBC Standards 2014, Appendix 6.1A, *Map showing categories of exposure to wind-driven rain*.

5 Practicability of installation

The product is designed to be installed by competent general builders or contractors experienced with this type of product.

6 Weathertightness



6.1 The product is classified as Class W1* in accordance with BS EN 13859-2 : 2014 and will resist liquid water penetration and wind-blown snow, and will protect the sheathing and frame from external moisture.

6.2 The product can be used as temporary weather protection during construction, prior to the completion of external brickwork or claddings. The period of such use should, however, be kept to a minimum.

7 Risk of condensation



7.1 For design purposes, the product's water vapour resistance may be taken as less than or equal to $0.6 \text{ MN}\cdot\text{s}\cdot\text{g}^{-1}$ and it is classified as a breather membrane in accordance with BS 5250 : 2011. Walls incorporating the product will, therefore, adequately limit the risk of interstitial condensation when designed and constructed in accordance with BS 5250 : 2011, Annex G.

7.2 The risk of condensation occurring within the wall of a timber-frame building will depend upon the properties and vapour resistance of other materials used in the construction, the internal and external conditions, and the effectiveness of the internal vapour control layer.

8 Strength

8.1 The product will resist the normal loads associated with construction and installation of timber-frame structures.

8.2 The product is not adversely affected by water and will retain its mechanical properties when wet.

9 Properties in relation to fire



9.1 The product is classified as Class E* in accordance with BS EN 13501-1 : 2007. Where the product forms the face of a cavity the permissible areas of use and the spacing of cavity barriers are restricted by the national Building Regulations.



9.2 The product should not be used on buildings in England that have a storey at least 18 m above ground level and contain: one or more dwellings, an institution, a room for residential purposes (excluding any room in a hostel, hotel or boarding house), student accommodation, care homes, sheltered housing, hospitals or dormitories in boarding schools.

10 Maintenance

As the product is confined within the wall space and has suitable durability (see section 11), maintenance is not required. However, any damage occurring before enclosure must be repaired (see section 15).

11 Durability



The product will be unaffected by the normal conditions found in timber-frame walls and will have a life equal to that of the building in which it is installed.

12 Reuse and recyclability

The product contains polypropylene, which can be recycled.

Installation

13 General

Buildbase Supplied By IKO — Breather Membrane for use in Timber Frame Constructions must be installed in accordance with the Certificate holder's instructions and, where appropriate, the recommendations given in *NHBS Standards 2014, Chapter 6.2 External timber-framed walls*.

14 Procedure

14.1 The product must be secured at regular intervals not exceeding 500 mm, with stainless steel staples or nails, to prevent damage by wind action.

14.2 Upper layers should overlap lower layers to shed water away from the sheathing. Vertical laps should be staggered wherever possible (see Figure 1).

Figure 1 Membrane installation

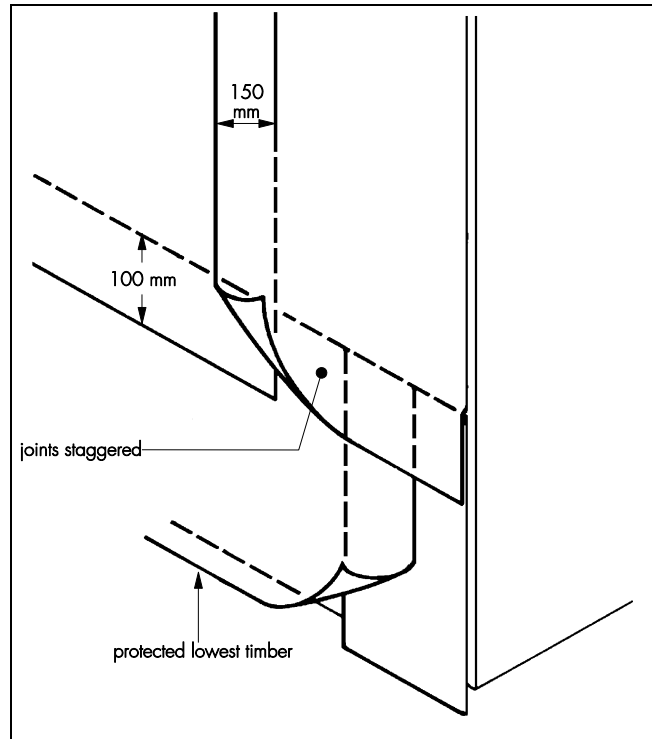

14.3 Horizontal and vertical laps should be a maximum of 100 mm and 150 mm respectively.

14.4 It is essential that the positions of the studs are marked on the face of the breather membrane (usually by tape) to enable fixing of wall ties and battens.

14.5 It is essential that the lowest timbers in the wall are protected by the breather membrane.

15 Repair

The product can be damaged by careless handling, high winds or vandalism. Damage to the membrane must be repaired prior to the installation of external walls or cladding by laying another sheet over the damaged area, and patching and sealing correctly, ensuring water is shed away from the sheathing.

Technical Investigations

16 Tests

An assessment was made on data to BS EN 13859-2 : 2014 in relation to:

- dimensions*
- mass per unit area*
- tensile strength and elongation*
- resistance to tear*
- dimensional stability*
- resistance to water penetration*
- resistance to artificial ageing*
- water vapour transmission*
- reaction to fire*.

17 Investigations

The manufacturing process was evaluated, including the methods adopted for quality control, and details were obtained of the quality and composition of the materials used.

Bibliography

BS 5250 : 2011 *Code of practice for control of condensation in buildings*

BS EN 13501-1 : 2007 *Fire classification of construction products and building elements — Classification using test data from reaction to fire tests*

BS EN 13859-2 : 2014 *Flexible sheets for waterproofing — Definitions and characteristics of underlays — Underlays for walls*

20 Conditions

20.1 This Certificate:

- relates only to the product/system that is named and described on the front page
- is issued only to the company, firm, organisation or person named on the front page – no other company, firm, organisation or person may hold claim that this Certificate has been issued to them
- is valid only within the UK
- has to be read, considered and used as a whole document – it may be misleading and will be incomplete to be selective
- is copyright of the BBA
- is subject to English Law.

20.2 Publications, documents, specifications, legislation, regulations, standards and the like referenced in this Certificate are those that were current and/or deemed relevant by the BBA at the date of issue or reissue of this Certificate.

20.3 This Certificate will remain valid for an unlimited period provided that the product/system and its manufacture and/or fabrication, including all related and relevant parts and processes thereof:

- are maintained at or above the levels which have been assessed and found to be satisfactory by the BBA
- continue to be checked as and when deemed appropriate by the BBA under arrangements that it will determine
- are reviewed by the BBA as and when it considers appropriate.

20.4 The BBA has used due skill, care and diligence in preparing this Certificate, but no warranty is provided.

20.5 In issuing this Certificate the BBA is not responsible and is excluded from any liability to any company, firm, organisation or person, for any matters arising directly or indirectly from:

- the presence or absence of any patent, intellectual property or similar rights subsisting in the product/system or any other product/system
- the right of the Certificate holder to manufacture, supply, install, maintain or market the product/system
- actual installations of the product/system, including their nature, design, methods, performance, workmanship and maintenance
- any works and constructions in which the product/system is installed, including their nature, design, methods, performance, workmanship and maintenance
- any loss or damage, including personal injury, howsoever caused by the product/system, including its manufacture, supply, installation, use, maintenance and removal
- any claims by the manufacturer relating to CE marking.

20.6 Any information relating to the manufacture, supply, installation, use, maintenance and removal of this product/system which is contained or referred to in this Certificate is the minimum required to be met when the product/system is manufactured, supplied, installed, used, maintained and removed. It does not purport in any way to restate the requirements of the Health and Safety at Work etc. Act 1974, or of any other statutory, common law or other duty which may exist at the date of issue or reissue of this Certificate; nor is conformity with such information to be taken as satisfying the requirements of the 1974 Act or of any statutory, common law or other duty of care.