



REF: BT002

## IKO BRITORCH SBS INSULATED – TORCH APPLIED SYSTEM

### SYSTEM INFORMATION

The IKO Britorch SBS Insulated – Torch Applied System is a built-up flat roof solution offering the specifier and client a premium flat roofing solution for new build and refurbishment projects.

This configuration is specific to a warm flat roof solution.

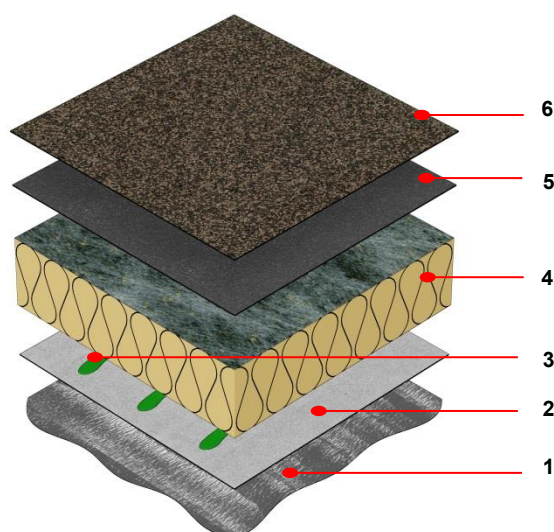

### USE

As a warm flat roof solution, this system has been developed with the roofing professional in mind, incorporating a range of high performance SBS modified waterproofing membranes used in conjunction with high performance insulation to provide a robust built-up roofing system.

### SUMMARY OF SYSTEM COMPONENTS

1. **IKOpro Easyseal Bonding Agent**  
*Fast-drying rubber modified bituminous priming solution designed to prepare substrates for the application of self-adhesive (S-A) bitumen waterproofing membranes.*  
**Pack size:** 5L  
**Typical Coverage:** 3-5 m<sup>2</sup>/litre\*  
**Product Code:** 2350005  
*\*Dependent on substrate and porosity.*
2. **IKO Easyseal Air & Vapour Control Layer**  
*High performance air and vapour control layer composed of a polyester reinforced aluminium core, coated with a rubber modified, self-adhesive bitumen coating.*  
**Roll size:** 15m x 1m  
**Roll weight:** 36 kg  
**Surfacing:** Fine mineral  
**Product Code:** 62130011
3. **IKOpro PU Insulation Adhesive**  
*Single component, moisture curing polyurethane adhesive for bonding rigid insulation boards.*  
**Size:** 6.5kg (6 litres)  
**Typical Main Roof Area Coverage:** 30-35m<sup>2</sup>/tin\*  
**Product Code:** 58800001  
*\*Dependant on surface porosity; coverage rate will be reduced at perimeter and exposed edge detailing.*
4. **IKO enertherm BGF Insulation**  
*High performance PIR insulation boards with composite PP fleece facing on both sides.*  
**Thermal conductivity:**  
0.026W/m<sup>2</sup>K (≤120mm), 0.027W/m<sup>2</sup>K (≥120mm)  
**Thickness:** Various\*  
*\*Insulation thickness should be determined by U-Value requirements.*
5. **IKO SBS Premium T-O Underlay**  
*High performance, SBS modified polyester reinforced bitumen torch applied underlay membrane.*  
**Roll size:** 8m x 1m  
**Roll weight:** 26 kg  
**Surfacing:** Sanded  
**Product Code:** 61120000
6. **IKO Britorch SBS Cap Sheet**  
*High performance polyester based SBS modified bitumen torch-on cap sheet.*  
**Roll size:** 8m x 1m  
**Roll weight:** 40 kg  
**Product Codes:** Green – 73017000; Black – 73016000;