



REF: ES001

## IKO EASYSEAL PRO INSULATED – COLD APPLIED SYSTEM

### SYSTEM INFORMATION

The IKO Easyseal Pro Insulated – Cold Applied System is a built-up flat roof solution offering the specifier and client a premium flat roofing solution for new build and refurbishment projects.

This configuration is specific to a warm flat roof solution.

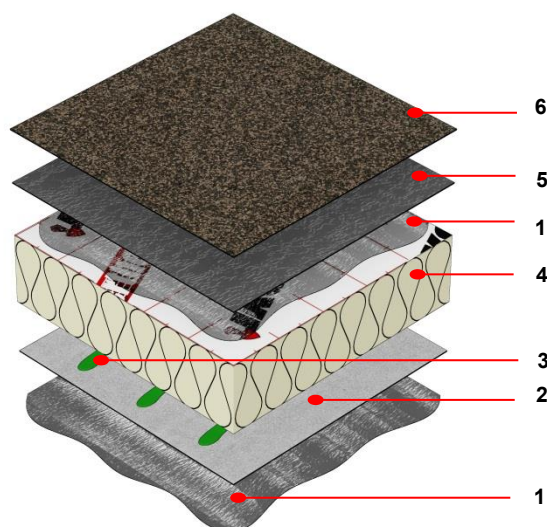

### USE

As a warm flat roof solution, this system has been developed with the roofing professional in mind, incorporating a range of high performance SBS modified waterproofing membranes to provide a robust built-up roofing system that is installed without the use of gas torches or bitumen boilers.

### FIRE PERFORMANCE

This IKO Easyseal Pro warm roof system build-up has been independently tested under ENV1187 Test 4: External fire exposure roof test and classified using BS EN 13501-5, achieving the highest performance designation of **Broof (t4)** to which enables unrestricted use within The Building Regulations 2010 - Fire Safety: Approved Document B.

### SUMMARY OF SYSTEM COMPONENTS

1. **IKOpro Easyseal Bonding Agent**  
Fast-drying rubber modified bituminous priming solution designed to prepare substrates for the application of self-adhesive (S-A) bitumen waterproofing membranes.  
**Pack size:** 5L  
**Typical Coverage:** 3-5 m<sup>2</sup>/litre\*  
**Product Code:** 2350005  
*\*Dependent on substrate and porosity.*
2. **IKO Easyseal Air & Vapour Control Layer**  
High performance air and vapour control layer composed of a polyester reinforced aluminium core, coated with a rubber modified, self-adhesive bitumen coating.  
**Roll size:** 15m x 1m, **Roll weight:** 36 kg  
**Surfacing:** Fine mineral  
**Product Code:** 62130011
3. **IKOpro PU Insulation Adhesive**  
Single component, moisture curing polyurethane adhesive for bonding rigid insulation boards.  
**Size:** 6.5kg (6 litres)  
**Typical Main Roof Area Coverage:** 30-35m<sup>2</sup>/tin\*  
**Product Code:** 58800001  
*\*Dependant on surface porosity; coverage rate will be reduced at perimeter and exposed edge detailing.*
4. **IKO enertherm ALU Insulation**  
High performance PIR insulation boards with composite aluminium facing on both sides.  
**Thermal conductivity:** 0.022W/m<sup>2</sup>K  
**Thickness:** Various\*  
*\*Insulation thickness should be determined by U-Value requirements.*
5. **IKO Easyseal Self-Adhesive Partially Bonded Underlay**  
High performance, self-adhesive SBS modified polyester reinforced bitumen membrane. The underside has a self-adhesive bitumen coating that provides a 40% partial bond allowing vapour dispersion between the membrane and substrate. The underside has a 75mm selvedge that facilitates a rapid installation of the lap joints.  
**Roll size:** 8m x 1m, **Roll weight:** 18 kg, **Surfacing:** film  
**Product Code:** 73170008
- 5a. **IKO Easyseal Self-Adhesive Fully Bonded Underlay**  
High performance, self-adhesive SBS modified polyester reinforced bitumen membrane. The underside has a self-adhesive bitumen coating for fully bonded and all waterproofing detailing applications.  
**Roll size:** 8m x 1m, **Roll weight:** 18 kg, **Surfacing:** film  
**Product Code:** 73070008
6. **IKO Easyseal Pro Cap Sheet**  
High performance polyester based SBS modified bitumen self-adhesive cap sheet with hot air welded laps, which incorporates a fire-retardant coating.  
**Roll size:** 8m x 1m, **Roll weight:** 30kg  
**Product Codes:** Black - 73000008