



REF: PT001

IKO PROTORCH INSULATED – HYBRID SYSTEM

SYSTEM INFORMATION

The IKO Protorch Insulated - Hybrid System is a built-up flat roof solution offering the specifier and client a premium flat roofing solution for new build and refurbishment projects.

This configuration is specific to a warm flat roof solution.

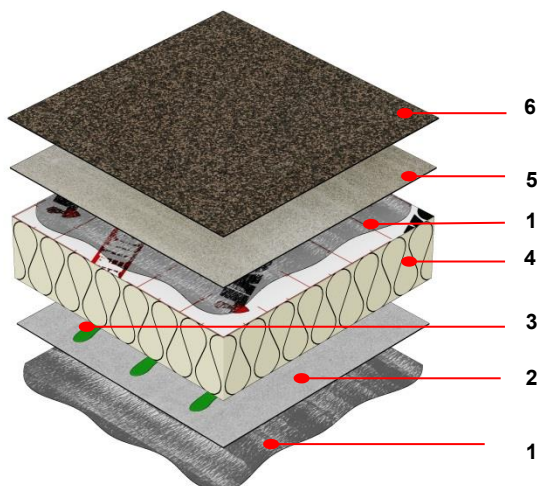

USE

As a warm flat roof solution, when combined with IKO Easyseal Air & Vapour Control Layer, the system can be installed up to and including to the underlay level without the need for hot works.

The warm roof system incorporates IKO Easyseal Heat-Activated Partially Bonded Underlay that is self-adhered directly onto a primed layer of IKO enertherm ALU insulation. A fully bonded version of this underlay is used for all detailing works.

The bond achieved by the IKO Heat Activated Underlays is further enhanced through application of the torch applied IKO Protorch Cap Sheet.

This build-up enables a cost-effective insulation to be specified whilst also protecting it from direct contact with the torch flame.

FIRE PERFORMANCE

This IKO Protorch warm roof system build-up has been independently tested under ENV1187 Test 4: External fire exposure roof test and classified using BS EN 13501-5, achieving the highest performance designation of **Broof (t4)** to which enables unrestricted use within The Building Regulations 2010 - Fire Safety: Approved Document B.

SUMMARY OF SYSTEM COMPONENTS

1. **IKOpro Easyseal Bonding Agent**
Fast-drying rubber modified bituminous priming solution designed to prepare substrates for the application of self-adhesive (S-A) bitumen waterproofing membranes.
Pack size: 5L, **Typical Coverage:** 3-5 m²/litre*
Product Code: 2350005
**Dependent on substrate and porosity.*
2. **IKO Easyseal Air & Vapour Control Layer**
High performance air and vapour control layer composed of a polyester reinforced aluminium core, coated with a rubber modified, self-adhesive bitumen coating.
Roll size: 15m x 1m, **Roll weight:** 36 kg, **Surfacing:** Fine mineral, **Product Code:** 62130011
3. **IKOpro PU Insulation Adhesive**
Single component, moisture curing polyurethane adhesive for bonding rigid insulation boards.
Size: 6.5kg (6 litres)
Typical Main Roof Area Coverage: 30-35m²/tin*
Product Code: 58800001
**Dependant on surface porosity; coverage rate will be reduced at perimeter and exposed edge detailing.*
4. **IKO enertherm ALU Insulation**
High performance PIR insulation boards with composite aluminium facing on both sides.
Thermal conductivity: 0.022W/m²K
Thickness: Various*
**Insulation thickness should be determined by U-Value requirements.*
5. **IKO Easyseal Heat-Activated Partially Bonded Underlay**
High performance, self-adhesive SBS modified polyester reinforced bitumen membrane. The underside has a self-adhesive bitumen coating that provides a 40% partial bond allowing vapour dispersion between the membrane and substrate. The underside has a 75mm selvedge that facilitates a rapid installation of the lap joints.
Roll size: 16m x 1m, **Roll weight:** 36 kg, **Surfacing:** Fine mineral, **Product Code:** 74170016
- 5a. **IKO Easyseal Heat-Activated Fully Bonded Underlay**
High performance, self-adhesive SBS modified polyester reinforced bitumen membrane. The underside has a self-adhesive bitumen coating for fully bonded and all waterproofing detailing applications.
Roll size: 16m x 1m, **Roll weight:** 36 Kg, **Surfacing:** Fine mineral, **Product Code:** 74070016
6. **IKO Protorch Cap Sheet**
High performance polyester based SBS modified bitumen torch-on cap sheet, which incorporates a fire-retardant coating.
Roll size: 8m x 1m, **Roll weight:** 40 kg
Product Codes: Green – 60510000; Blue/Grey – 60520000; Black - 60530000; Brown – 60540000