



REF: PT002

IKO PROTORCH INSULATED - TORCH APPLIED SYSTEM

SYSTEM INFORMATION

The IKO Protorch Insulated – Torch Applied System is a built-up flat roof solution offering the specifier and client a premium flat roofing solution for new build and refurbishment projects.

This configuration is specific to a warm flat roof solution.

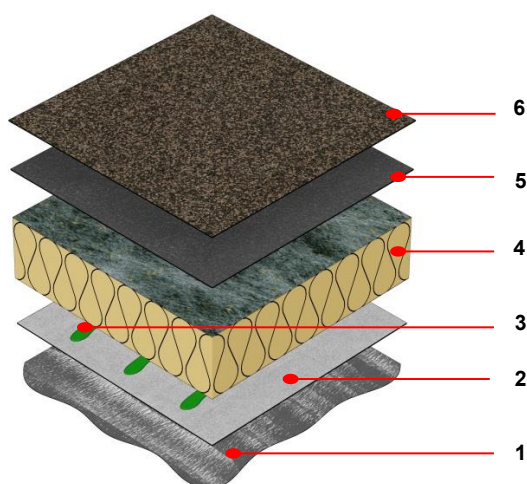

USE

As a warm flat roof solution, this system has been developed with the roofing professional in mind, incorporating a range of high performance SBS modified waterproofing membranes used in conjunction with high performance insulation to provide a robust built-up roofing system.

SUMMARY OF SYSTEM COMPONENTS

1. IKOpro Easyseal Bonding Agent

Fast-drying rubber modified bituminous priming solution designed to prepare substrates for the application of self-adhesive (S-A) bitumen waterproofing membranes.

Pack size: 5L

Typical Coverage: 3-5 m²/litre*

Product Code: 2350005

**Dependent on substrate and porosity.*

2. IKO Easyseal Air & Vapour Control Layer

High performance air and vapour control layer composed of a polyester reinforced aluminium core, coated with a rubber modified, self-adhesive bitumen coating.

Roll size: 15m x 1m

Roll weight: 36 kg

Surfacing: Fine mineral

Product Code: 62130011

3. IKOpro PU Insulation Adhesive

Single component, moisture curing polyurethane adhesive for bonding rigid insulation boards.

Size: 6.5kg (6 litres)

Typical Main Roof Area Coverage: 30-35m²/tin*

Product Code: 58800001

**Dependant on surface porosity; coverage rate will be reduced at perimeter and exposed edge detailing.*

4. IKO enertherm BGF Insulation

High performance PIR insulation boards with composite PP fleece facing on both sides.

Thermal conductivity:

0.026W/m²K (≤120mm), 0.027W/m²K (≥120mm)

Thickness: Various*

**Insulation thickness should be determined by U-Value requirements.*

5. IKO SBS Premium Torch on Underlay

High performance, SBS modified polyester reinforced bitumen torch applied underlay membrane.

Roll size: 8m x 1m

Roll weight: 26 kg

Surfacing: sanded

Product Code: 61120000

6. IKO Protorch Cap Sheet

High performance polyester based SBS modified bitumen torch-on cap sheet, which incorporates a fire-retardant coating.

Roll size: 8m x 1m

Roll weight: 40 kg

Product Codes: Green – 60510000; Blue/Grey – 60520000; Black - 60530000; Brown – 60540000