

# IKO enertherm Angle Fillets

## Technical Data Sheet – Section 12.00

### PRODUCT INFORMATION

IKO enertherm Angle Fillets are preformed triangular sections of insulation that comprise a protective facing, factory laminated to a high-performance CFC free rigid polyisocyanurate (PIR) foam insulation board.

The foam backing is chamfered to accommodate variations in internal angles.

Three types are available to suit the different follow-on systems:

#### **IKO enertherm ALU Angle Fillets**

Composite foil facing - product to be used within cold applied or hybrid roofing systems.

#### **IKO enertherm MG Angle Fillets**

Perforated coated glass fibre facing - product to be used within cold applied roofing or bitumen bonded systems.

#### **IKO enertherm BM Angle Fillets**

Polypropylene (PP) coated bituminised sand and talc free glass fibre facing - product to be used with torch applied roofing systems.



Product Description	Product Code
enertherm ALU Angle Fillet	EALUAF50
enertherm BM Angle Fillet	EBMAF50
enertherm MG Angle Fillets	EMGAF50

### USE

IKO enertherm Angle Fillets are adhered and used in conjunction with Reinforced Bitumen Membrane in flat roof waterproofing systems, at all junctions of the vertical and horizontal abutment.

Where these products are utilised within IKO Approved Contractor network and guided by an IKO Specification document, where omission or differing information exists the IKO Specification document will take precedence.

### COMPOSITION

Core:	PIR
Facing options:	See above
Length:	1200mm
Width:	50mm x 50mm

## **FEATURES AND BENEFITS**

- Lightweight and easy to use
- Suitable for the application of Reinforced Bitumen Membranes
- Angle fillets can be secured in IKOpro PU adhesives
- Suitable for use with any proprietary flat roof board insulation materials
- Versatile facings to meet application method
- Dimensionally stable
- Chamfered corner to suit varying internal angles

## **INSTALLATION**

IKO enertherm angle fillets should be installed at all horizontal and vertical abutments within a reinforced bitumen membrane roofing application.

They should be bonded in IKOpro PU adhesive with the facing upper most.

All Insulation and angle fillets must be covered immediately with the specified waterproofing system and not left exposed to inclement the weather.

Reinforced Bitumen roofing membranes should be installed in accordance with BS 8217: 2005, Code of Practice for reinforced bitumen membranes, fully bonded directly to the angle fillet.

When installing self-adhesive membranes, the protection board facing must first be primed with the specified self-adhesive primer.

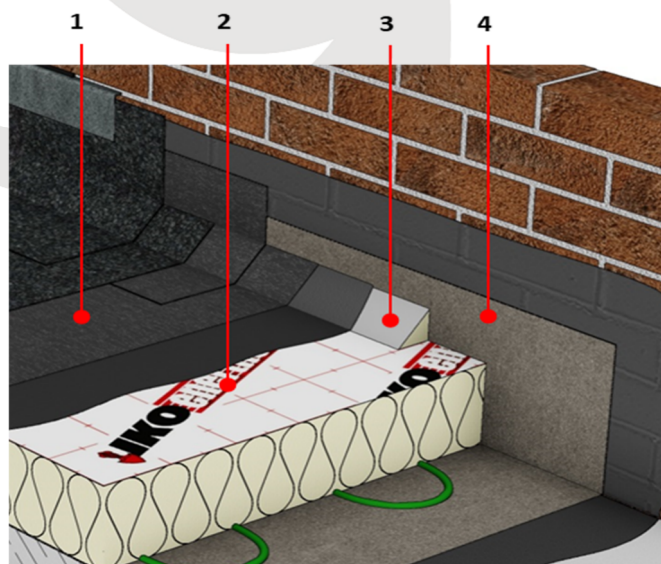

**Key:**

1. Waterproofing layer(s)
2. Insulation if applicable
3. IKO enertherm Angle Fillet
4. Air and Vapour Control Layer

## **OTHER RELEVANT DOCUMENTATION**

Where applicable, Material Safety Data Sheets (MSDS), Declaration of Performances (DoPs), and Third-Party Accreditations are available to view and download from the IKO website Resource Centre:

<https://ikogroup.co.uk/resource-centre/>

## **PRODUCT SUPPORT**

Should you have any queries in relation to this product please contact one of the relevant teams below:

<b>Technical</b>	<a href="mailto:technical.ab@iko.com">technical.ab@iko.com</a> <ul style="list-style-type: none"><li>- For Reinforced Bitumen Membranes, IKOpro and Flexia Liquid Applied Waterproofing, Pitched Roofing, IKO Hyload Structural Waterproofing</li></ul> <a href="mailto:technical.ma@iko.com">technical.ma@iko.com</a> <ul style="list-style-type: none"><li>- For Mastic Asphalt</li></ul> <a href="mailto:technical.cc@iko.com">technical.cc@iko.com</a> <ul style="list-style-type: none"><li>- For Single Ply and Permasec Hot Melt</li></ul>
<b>Sales</b>	<a href="mailto:sales.uk@iko.com">sales.uk@iko.com</a>
<b>Marketing</b>	<a href="mailto:getintouch.uk@iko.com">getintouch.uk@iko.com</a>

## **COMPANY ACCREDITATIONS**

IKO PLC, a roofing, waterproofing, and insulation company, holds various accreditations that demonstrate its commitment to quality, safety, and environmental responsibility. These include ISO certifications for quality management and occupational health and safety, British Board of Agrément (BBA) accreditations for specific products and systems, and Factory Mutual (FM) approval for certain roofing systems.

All our manufacturing plants have BS EN ISO 9001, BS EN ISO 14001, BS EN ISO 45001, and BES 6001 accreditation, meaning we match the quality and sustainability requirements and use responsibly sourced raw materials in our production. We also re-use by-products from manufacture, wrap products in minimal packaging, and we employ a streamlined transportation network.



IKO is also a leading member of all relevant trade associations such as NFRC, BFRA, SPRA, LRWA, MAC, RSTA, BJA and LCRIG having technical experts within the technical and standards committees to help us get informed first-hand about recent updates on technical requirements for the design and installation of roofing, waterproofing, road and bridge maintenance industry products.



## **DISCLAIMER**

Whilst every precaution is taken to ensure that the information given in this literature is correct and up-to-date it is not intended to form part of any contract or give rise to any collateral liability, which is hereby specifically excluded.

IKO reserves the right to amend and/or withdraw this document without notice.

Intending purchasers of our materials should therefore verify with the company whether any changes in our specification, application details, withdrawals or otherwise have taken place since this literature was published.